

Honeycomb Freehanging Blinds

Page 1

Installation Guide

⚠ Caution

1. Please read this manual before installation and use
2. This guide assumes you have basic skills in drilling walls and ceilings
3. Do not disassemble the blind if you believe something is not working
4. All components are self-lubricating, no extra lubricant is required

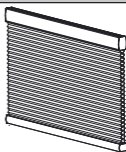

Recommended installation tools



Drill



Hammer



Screwdriver



Tape measure



Pencil

Please be sure that you are competent in using these tools before attempting the installation

Brackets

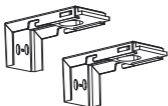

You will receive the recommended number of brackets to suit the width of each blind. Please count the total number of brackets received for each blind before commencing the installation

Attaching the blinds to the brackets

It's a good idea to start by attaching a bracket to a blind so that you have an understanding of how to do it once the brackets are on the wall.

The brackets will attach to the top of the headbox. You will notice that the brackets have a sprung plate. The principal idea is to slot the sprung plate under the 'lip' found on the top of the headbox on the front edge (the front edge will be the front of the headbox that you will see when the blind is fitted). Then push the headbox towards the bracket so that the sprung plate compresses, and then you will be able to slot the 'lip' of the rear edge of the headbox onto the hook shaped part of the bracket.

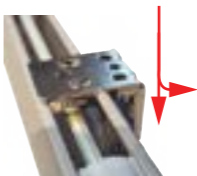

Honeycomb Freehanging Blinds

Position the brackets

The brackets must be positioned along the blind so as to not interfere with the components in the headrail. You will notice that the brackets cannot fit in the position where there are cord spools, or other large components. The images below show suitable positions. It is recommended that you position the brackets along the blind at this stage to make positioning the bracket on the wall easier.

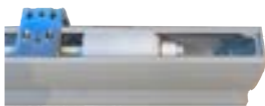

Outside the recess installation

Firstly, consider the fixing height of the blind. You will need to know the height of the blind ordered. Make a mark on the wall at the top position of the blind. If necessary draw a line to make it easier for yourself to see later.

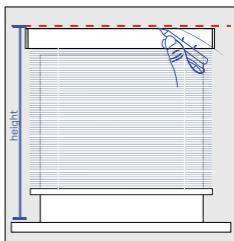

Once you've marked out the 'top of the bracket' position, the easiest way to mark your bracket positions is to offer the blind up to the wall and mark the position of the bracket on the horizontal line you made in the last step. Of course this assumes that you have placed the brackets on the headrail already (as recommended).

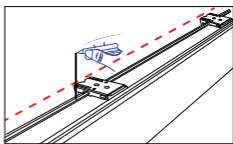

After removing the brackets from the headrail, mark the hole positions using the bracket as a guide, and drill your holes.

You should use two screws per bracket.

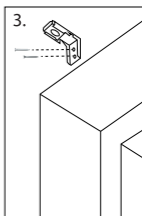
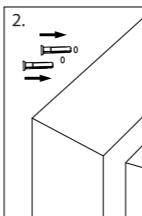
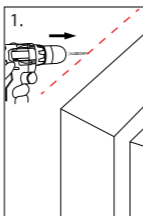

Honeycomb Freehanging Blinds

Page 3

Installation Guide

Inside the recess installation

If you've already attached the brackets to the blinds as recommended, then offer the blind up into the recess and mark the brackets positions on the wall.

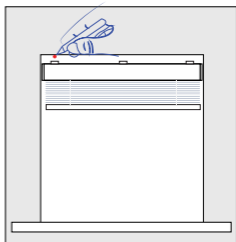
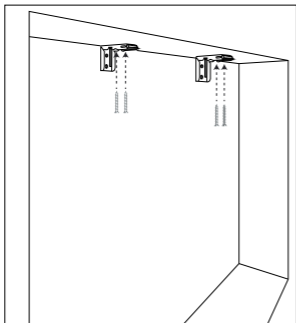

Place each bracket into the correct position and use the bracket as guide for marking your hole positions.

Drill your holes, and use the wall plugs provided (if you are fixing into concrete)

You can also use this bracket to 'face fix' into something like a wooden window frame if you think it will be more suitable.

Hanging the blind

Whether you fixed inside or outside the recess, you must hang the blind in the same way. Offer the blind to the brackets and clip it in as explained at the beginning of this guide.

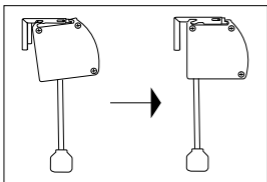

Initially, pull the blind down and centralise the fabric if necessary

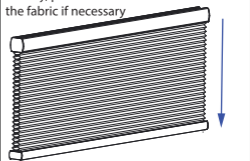

Installing child safety devices

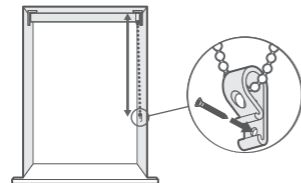

The cord retaining device must be installed at the maximum distance possible from the control mechanism, to prevent looped cords from becoming slack.

Place the retaining device on the wall and mark the position of the screw hole(s) with a pencil.

Attach the retaining device to the wall using the fixings provided.

The retaining device must not be less than 150cm from the floor.